

Fixed Price House & Land Package

PORTER DAVIS

COLLECTION

TOTAL PACKAGE PRICE

~~\$652,900~~

60 DAY SALE PRICE

\$627,900*

OFFER ENDS MARCH 30TH 2019



Coburn façade

Facade image may include upgrade items not included in fixed price, please speak to your sales consultant.

Riverside 25



Lot 2095 Field Street, Helensvale

LOT SIZE: 448m² HOUSE SIZE: 233m²

FIXED PRICE PACKAGE INCLUSIONS:

- ⊕ Fixed price site costs
- ⊕ Stainless steel kitchen appliances
- ⊕ Stylish flooring to entire home
- ⊕ Landscaping to front of home including letterbox
- ⊕ Exposed aggregate driveway with path to portico
- ⊕ Spacious open plan living with alfresco
- ⊕ Colorbond roof
- ⊕ Fully rendered finish to Hebel
- ⊕ Easy access to M1 north and southbound, making travel to Brisbane or beyond a breeze
- ⊕ 6 star energy rating compliance

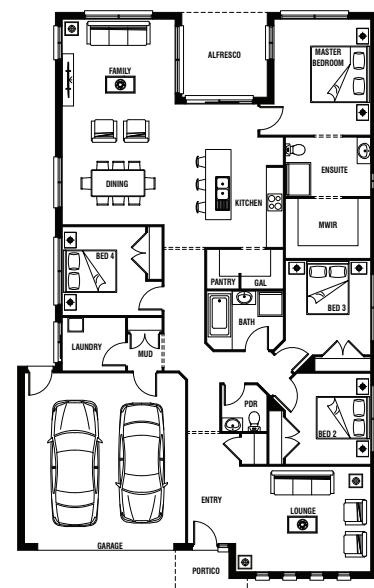

Contact Michael Marinov
0412 710 554
qld.porterdavis.com.au

The
SURROUNDS
by Villawood

Terms & Conditions: *60 Day Sale offer valid for Prestige and Collection ranges on vacant blocks in new housing estates only. Offer is not available on knockdown rebuilds. Offer available when depositing on a new Porter Davis home between 29th January - 30th March 2019 only. Package price is based on standard home, standard façade unless specified, builder's preferred siting and current promotion. Refer to sales consultant for actual working drawings for available façade options and inclusions. Pricing may vary due to actual land availability. Porter Davis reserves the right to change prices without notice. Fixed price packages are subject to developer's design review panel for final approval. First Home Buyer price less First Home Owner Grant subject to SRO eligibility criteria. † Start subject to land title & finance availability. ‡ Construction Times. Please see website for details. Rent relief up to a maximum of \$50.00 per calendar day if guaranteed completion time not met. ^ Site costs on untitled land are subject to second soil test and survey to confirm fill and fall levels as per developer's original engineering specifications, for all quotes other than fixed price house and land packages. This work is exclusively owned by RSS Property Holdings and cannot be reproduced or copied either wholly or in part, in any form (graphic, electronic or mechanical, including photocopying and uploading to the internet) without the written permission of RSS Property Holdings. Images include examples of upgrade items and other items not supplied by Porter Davis, such as landscaping, water features, pools, pool fences, decorative lighting, and furniture. Garage dimensions are external measurements only. Refer to actual working drawings. Information in this brochure is correct at time of printing. Porter Davis Homes takes no responsibility for changes that occur after this date, errors or omissions. Facade image may include upgrade items not included in fixed price, please speak to your sales consultant. Please check currency of information with your Sales Consultant. Effective 13.03.19 PDH QLD Pty Ltd - QBCC 15007714